

Main Hood:

W = belt width, in.

Q_E = 75 cfm per inch of belt width

Auxiliary Hood:

L_A = auxiliary hood length to extend 3" - 6" into end of sanding area.

Q_A = 135 cfm per ft of hood length

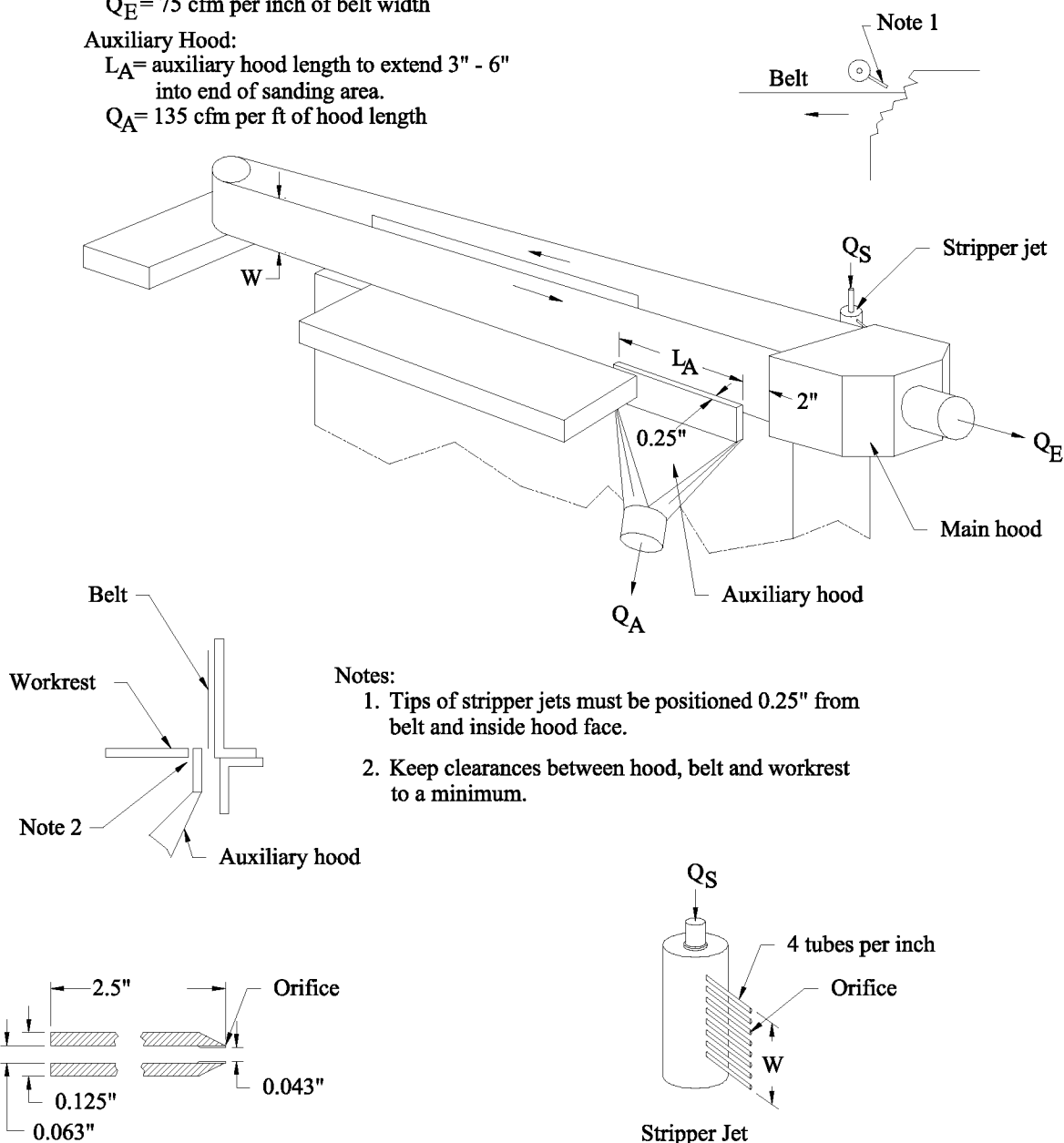

Notes:

1. Tips of stripper jets must be positioned 0.25" from belt and inside hood face.
2. Keep clearances between hood, belt and workrest to a minimum.

Tube and Orifice Detail

Reference 10.95.1

W = belt width, in.

Q_S = 0.5 cfm per tube,
inlet pressure 10 - 12 psig



TITLE

**HORIZONTAL BELT
SANDER STRIPPER
SYSTEM**

FIGURE

VS-95-14

DATE

12-90